

## How to Use USBTreeView to Help Troubleshoot Your USB Connection?

1. Download USBTreeView\_ver 4.0 from <https://www.newnex.com/resources/usbtreetview.zip>
2. Unzip the package and run “UsbTreeView.exe” in the folder
3. Click “Expand for Child Devices” to view your entire USB devices in a tree view, including root hub, controller, hub, peripherals, etc.

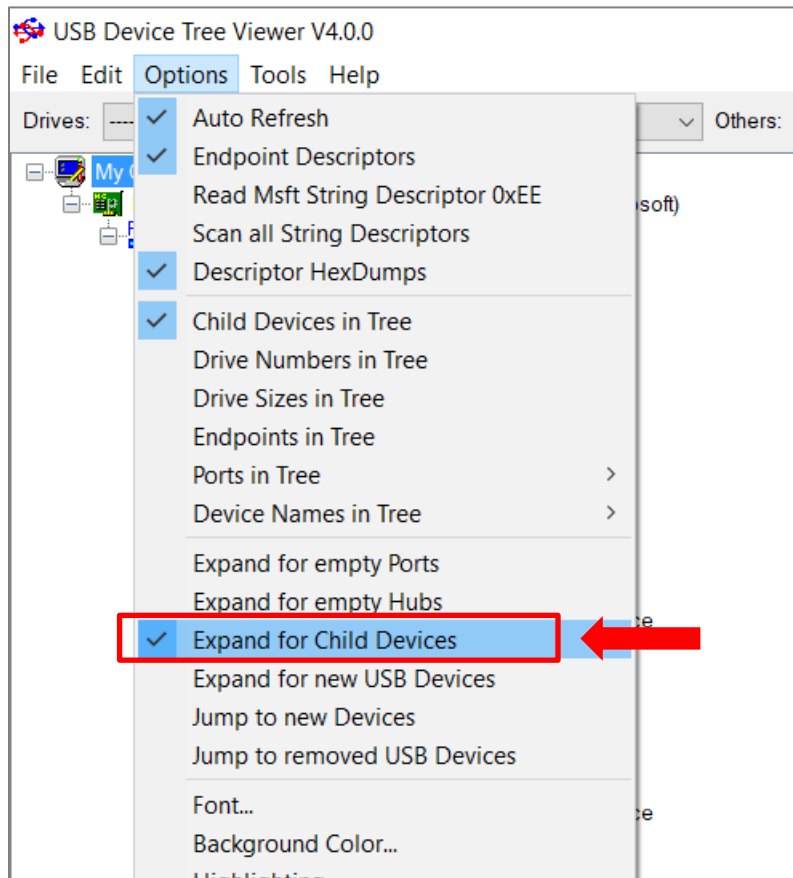

4. The unsuccessfully connected device will not be shown or highlighted in Yellow if running into some error during enumeration.

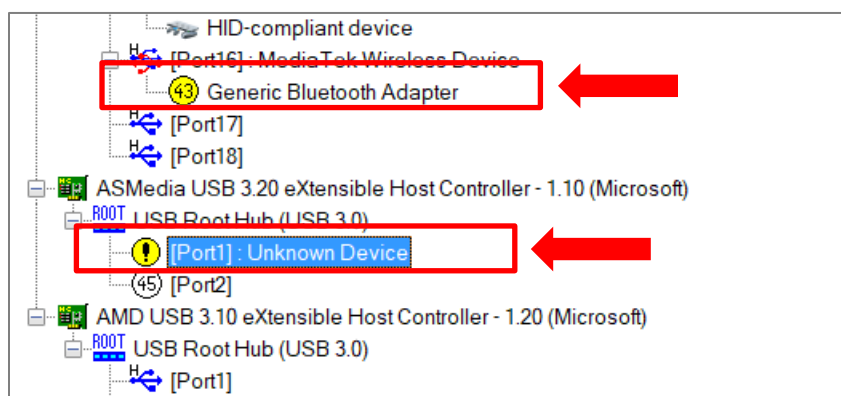

**5. You may save your tree view into XML file to share with others for troubleshooting**

